

Product Range



Rocker & Paddle Switches

- **Rocker & Paddle Switches for Panel Mounting:**
F, TRD and Gemini Series
- **Rocker & Paddle Switches for PCB Mounting:**
Gemini Series

Main features:

- Sealed or unsealed versions
- Various switch functions
- Gold or silver contacts
- LED illumination available (also bi-color)
- Multiple rocker/paddle colors available
- Beveled frames available



F Series, Power Rocker, Panel Mounting, 6Apage F2



TRD Series, Rocker/Paddlepage F4



Gemini A Series Rocker/Paddlepage F7



Gemini AE Series Rocker/Paddlepage F17

F Series, Rocker/Paddle, Panel Mounting, 6A

Features

- Wide range switch functions available
- Terminals are gold-flashed to prevent oxidation and for ease of soldering



Typical performance characteristics

Number of poles 1 to 4 pole
 Switch functions ON-ON, ON-(ON), ON-OFF-ON, ON-ON-ON, ON-OFF-(ON), (ON)-OFF-(ON)
 Contact rating 6 A @250 VAC, 6 A @125 VAC; gold contact: 0,4 VA max 20 V AC/DC
 Electrical life 25,000 to 50,000 cycles
 Mechanical life 50,000 to 100,000 cycles
 Contact resistance max 10 mOhm
 Insulation resistance min 1,000 MOhm
 Dielectric strength 1,000 VAC for 1 min
 Actuation force max 19,6 N
 Panel cut-out Ø 6,2 mm
 Standards and specs UL, CSA

Environmental specification

Operating temperature -20 to +70°C
 Storage temperature -20 to +70°C
 Vibration resistance 1,5 mm 10-55 Hz
 Shock resistance 50 g for 11±1 msec
 Terminal strength 24,5 N

Material specifications

Contacts brass silver alloy finished
 Toggle brass chromium plated
 Terminals brass plate
 Case phenol resin
 Cover steel zinc plated
 Seal rubber seal, insert molded rubber
 RoHS compliance compliant

Rocker & Paddle Switches

Product key

Typical product key

F L N 1 9 red 04

Type
F F Series power rocker switch

Model
L snap-in lever & rocker

Switch function & poles
1 pole **2 pole**
D ON-ON **N** ON-ON

Actuator
1 long rocker **2** small rocker

Terminal type
9 leadwire hooking type

Contact material
blank silver **G** gold

Rocker color
red red **black** black **white** white

Material
04 RoHS compliant

F Series, Rocker/Paddle, Panel Mounting, 6A (Continued)

Function

Function	Poles	On	On	On	On
D	1	On	On	1-2	2-3
N	2	On	On	1-2, 4-5	2-3, 5-6

Off indicates a mechanical position with no electrical connection
 (On) indicates momentary connection
 None indicates no mechanical position

Actuator

Code 1 long rocker

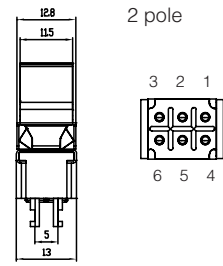
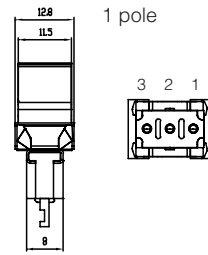
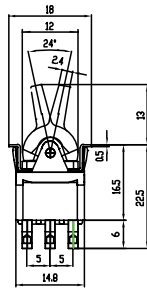

Code 2 small rocker

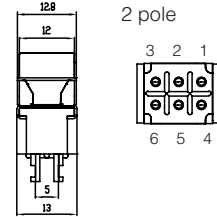
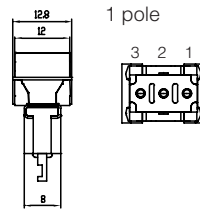
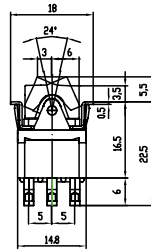

Terminal

Leadwire hooking type

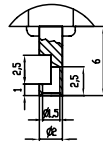

Mounting

Panel Cutout thickness 1 to 2.5mm

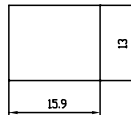

Product key	Poles	Switch func.	Actuator	Act. Color	Terminal	Contacts	Material	Part Number
FLD19black04	1 pole	On - On	long rocker	black	leadwire hooking type	silver	RoHS compliant	3-6437630-2
FLD29black04			small rocker	black				2-6437630-9
FLN19black04	2 poles		long rocker	black				3-6437630-7
FLN19red04				red				2-6437630-7
FLN19white04				white				2-6437630-6
FLN29black04			small rocker	black				2-6437630-5
FLN29red04				red				4-6437630-7
FLN29white04				white				2-6437630-3

TRD Series, Rocker/Paddle

Features

- Wire lug, quick connect, or PC terminals
- LED both single and bi-colored available
- Entire series epoxy sealed terminals



Typical performance characteristics

Contact configuration SPST, DPDT
 Contact timing break-before-make
 Contact rating max 3 A @ 125 VAC with silver Option 3, 0.4 VA @ 20 VDC gold option 1
 Electrical life. 2 Pos.: 20,000 cycles @ full rated 3 A load
 80,000 cycles @ 0.4 VA
 3 Pos.: 10,000 cycles @ full rated 3 A load
 60,000 cycles @ 0.4 VA
 Initial contact resistance. max.20 mOhms
 Insulation resistance. 1,000 MOhms min. @ 500 VDC
 Dielectric strength. 500 Volts rms @ sea level

Environmental specification

Operating temperature -20°C to +80°C
 Storage temperature -45°C to +93°C
 Solder heat resistance wave solder capable to 265°C
 hand solder max. 316°C for less than 5 seconds
 with switch in the closed position
 Seal epoxy sealed terminals

Material specifications

Contacts movable. copper alloy w/silver inlay or gold plated
 Actuator brass nickel plated
 Terminals/fixed contacts. copper alloy w/silver inlay or gold plated
 Housing/beveled frame polyamide, black matte finish
 Terminal seal epoxy
 RoHS Directive 2002/95/EC compliant

Rocker & Paddle Switches

Product key		Typical product key		TRD 1 3 D 1 0		WL		04	
Type	TRD Rocker/Paddle Switch								
Number of poles	1 single pole	2	double pole						
Rating	1 0.4 VA @20VDC (Gold)	3	3A @ 125VAC or 28VDC (Silver)						
Function	single pole D on-on E on-off-on F on-(on) G (on)-off-(on)	double pole N on-on P on-off-on S (on)-off-(on)							
Actuator	1 rocker	2	paddle						
Actuator color	0 black	2	red						
Terminals	WL wire lug	QC	quick connect						
Mount	blank 11.91 mm (15/32")								
LED illumination	blank none	LR	LED integral w/rocker (TRD1 only)						
LED color	2 red	5	green	25	bi-color red/green				
Material	blank RoHS compliant	04	RoHS compliant						

TRD Series, Rocker/Paddle (Continued)

Function



Codes 1, 2 1 and 2 pole



1 Single pole

Function	1-2-3	1-2-3	1-2-3
D	On	None	On
E	On	Off	On
F	On	None	(On)
G	(On)	Off	(On)
Terminals connected	2 - 3	---	1 - 2



2 Double pole

Function	1-2-3	1-2-3	1-2-3
N	On	None	On
P	On	Off	On
S	(On)	Off	(On)
Terminals connected	2 - 3	---	1 - 2
	5 - 6	---	4 - 5

Off mechanical position, no electrical connection
 (On) momentary mechanical position and electrical connection
 None no mechanical position

Actuator



1 rocker

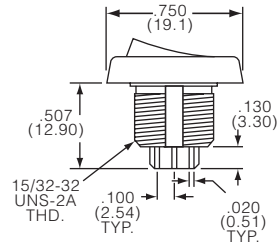
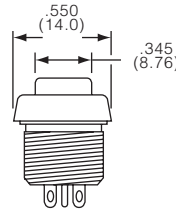
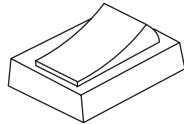

2 paddle

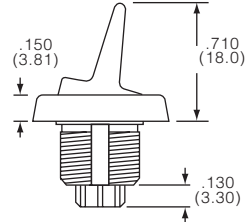
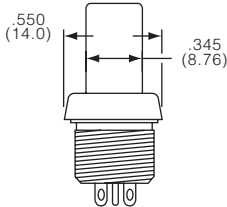
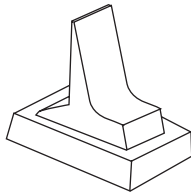

Terminal



QC, WL

QC, quick connect

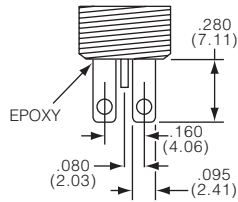

WL, wire lug

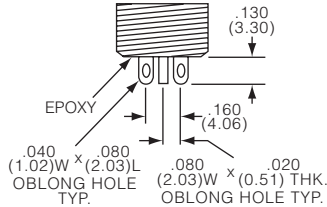

TRD Series, Rocker/Paddle (Continued)



blank 15/32" round hole

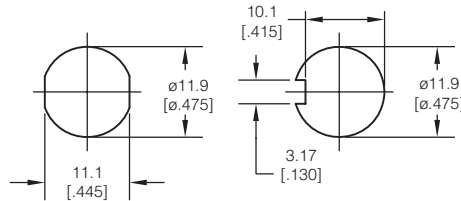

Standard TRD bushing will mount in any hole shown. Recommended panel thickness: .030" to .250". One hex nut, one internal tooth lock washer supplied



LR integral w/rocker (TRD1 only)



TRD11D10WLLR

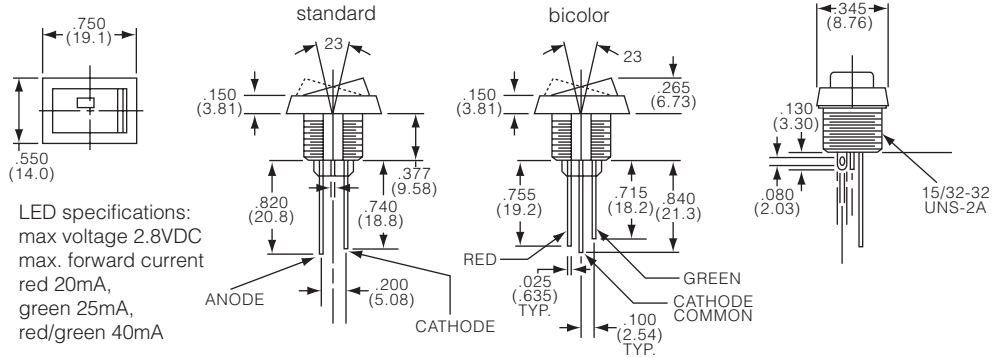

LED specifications:
max voltage 2.8VDC
max. forward current
red 20mA,
green 25mA,
red/green 40mA

Product key	Poles	Rating	Function	Actuator	Act. color	Terminals	LED	LED color	Material	Part Number
TRD11D10WL	single pole	0.4 VA @ 20VDC	on-on	rocker	black	wire lug	none	none	RoHS compliant	4-1437595-1
TRD11D10WLLR504						lug	integral	green		1825424-1
TRD11F10QCLR204		gold	on-(on)			quick c.		red		1825425-1
TRD11F10WL			(on)-off-(on)			wire lug	none	none		5-1437595-2
TRD11G10WL						lug				5-1437595-6
TRD13D10QC04		3 A	on-on			quick c.				1825422-1
TRD13D10WL04		@ 125VAC				wire lug				1825420-1
TRD13D10WLLR204		or 28VDC					integral	red		1825426-1
TRD13D10WLLR2504		silver						bi-color		1825426-2
TRD13D10WLLR504								green		1825426-3
TRD13E10WLLR204			on-off-on					red		1825426-4
TRD13F10QC04			on-(on)			quick connect	none	none		1825422-2
TRD13F10QCLR204						connect	integral	red		1825427-1
TRD13F10WL04						wire lug	none	none		1825420-2
TRD13G10WL04			(on)-off-(on)			lug				1825420-3
TRD13G10WLLR204							integral	red		1825426-5
TRD21N10WL	double	0.4 VA	on-on				none	none		1437596-3
TRD21S10WL		gold	(on)-off-(on)							1-1437596-4
TRD23N10QC04		3 A	on-on			quick c.				1825423-1
TRD23N10WL04		@ 125VAC				wire lug				1825421-1
TRD23P10WL04		or 28VDC	on-off-on							1825421-2
TRD23S10WL04		silver	(on)-off-(on)							1825421-3

Gemini A Series Rocker/Paddle

Features

- Multiple actuator colors available
- G and Q contacts UL® recognition

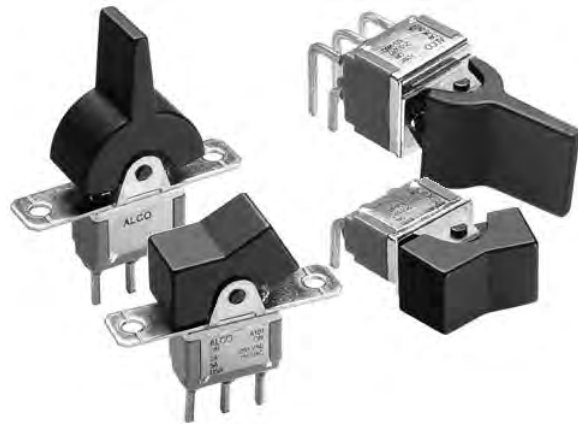

Typical performance characteristics

Contact configuration SPST, DPST
 Contact timing break before make
 Contact rating max. B contacts: 0.4 VA @ 20 V max. AC or DC
 G contacts: 0.4 VA @ 20 V max. AC or DC or
 5 A @ 120 VAC or 28 VDC (resistive) or
 2 A @ 250 VAC (resistive)
 Q contacts: 5 A @ 120 VAC or 28 VDC (resistive) or
 2 A @250 VAC (resistive)
 Electrical life 6,000 cycles at rated load
 Mechanical life 40,000 cycles
 Contact resistance max. 10 mOhms initial @ 2-4 VDC, 100 mA
 Insulation resistance min. 1,000 MOhms
 Dielectric strength 1,000 Vrms at sea level
 Standards and specs UL® recognition on G & Q contacts

Environmental specification

Operating temperature -30°C to 85°C
 Storage temperature -40°C to 85°C
 Solder heat resistance wave solder capable to 265°C

Material specifications

Contacts & terminals B contacts: copper alloy w/ gold over nickel
 G contacts: copper alloy w/ silver
 Q contacts: copper alloy w/ gold over silver
 Actuator phenolic
 Base DAP® UL94 V-O
 Frame stainless steel
 Seal epoxy UL94 V-1
 RoHS Directive 2002/95/EC compliant

Product key		Typical product key																		
				A		1		01		J1		A		Q		0		04		
Type	Rocker/Paddle Switch																			
Number of poles	1 single pole		2 double pole																	
Function	01 On-On		07 On-Off-(On)		13 On-On-(On)															
	03 On-Off-On		08 On-(On)																	
	05 (On)-Off-(On)		11 On-On-On																	
Actuator																				
Rocker											Paddle									
J1 small											J2 small									
J3 large											J4 large									
J50 snap-in											J60 snap-in									
J51 snap-in w/beveled frame											J61 snap-in w/beveled frame									
J52 snap-in w/beveled frame and LED											J62 snap-in w/beveled frame and LED									
Terminals																				
A right angle											V3 vertical with support bracket .620(15.75)									
AV2 vertical R/A											Z wire lug									
C P.C.											Z3 quick connect									
Contacts	B gold		G gold over silver		Q silver															
Actuator color	0 black (std.)		3 orange		6 blue															
	1 brown		4 yellow		8 gray															
	2 red		5 green		9 white															
Beveled frame color	0 black (std.)		3 orange		6 blue															
	1 brown		4 yellow		8 gray															
	2 red		5 green		9 white															
Material	04 RoHS compliant																			

Rocker & Paddle Switches

Gemini A Series Rocker/Paddle (Continued)

Function



Codes 01, 03, 05, 07, 08, 11 and 13

Code	Positions			
01	2 positions	On	None	On
08	2 positions	On	None	(On)
	Term. conn.	2 - 3	---	1 - 2
03	3 positions	On	Off	On
05		(On)	Off	(On)
07		On	Off	(On)
	Terminals connected	2 - 3	---	1 - 2
		5 - 6	---	4 - 5
11	3 positions	On	On	On
13		On	On	(On)
	Terminals connected	2 - 3	1 - 2	1 - 2
		5 - 6	5 - 6	4 - 5

Off
(On)
None

mechanical position, no electrical connection
momentary mechanical position and electrical connection
no mechanical position

Actuator



J1 rocker, small

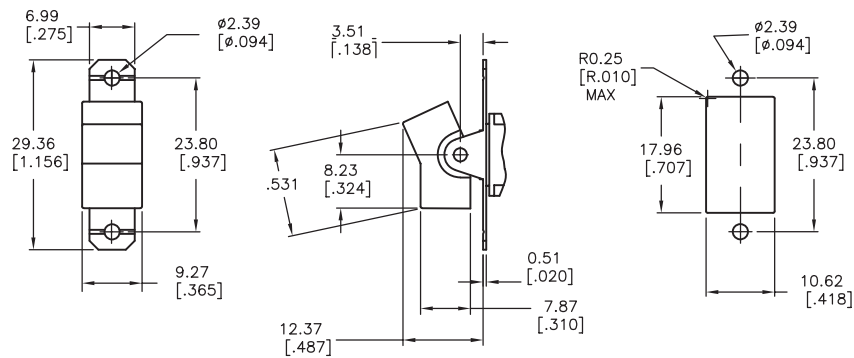
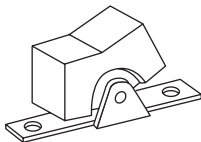

J3 rocker, large

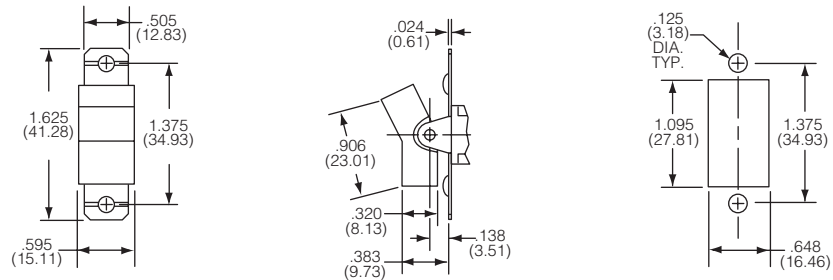
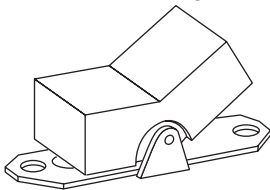

J50 rocker, snap-in

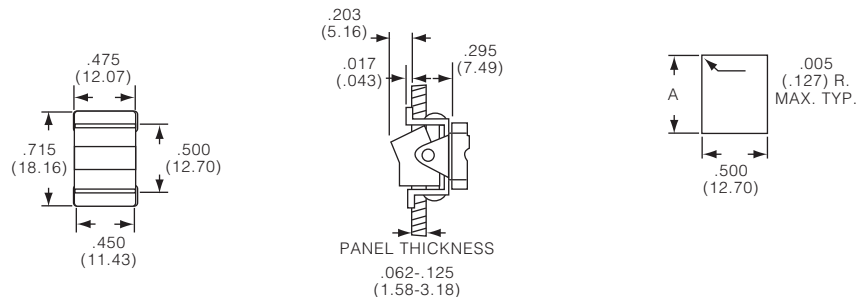
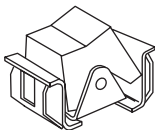

Gemini A Series Rocker/Paddle (Continued)

J51 rocker, snap-in w/beveled frame

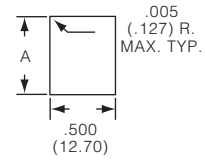

J52 rocker, snap-in, w/beveled frame and LED

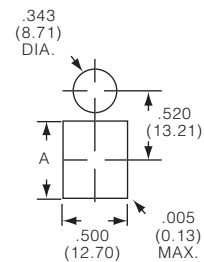
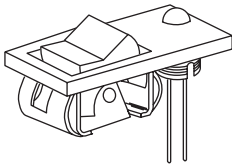

J2 paddle, small

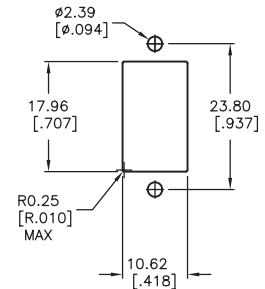
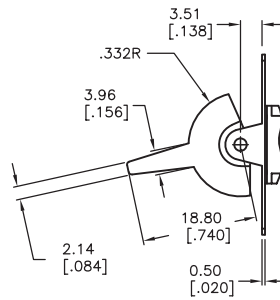
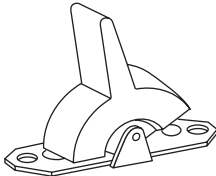

J4 paddle, large

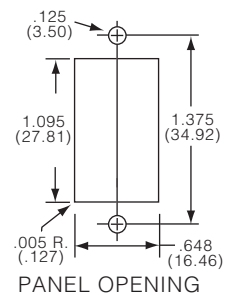
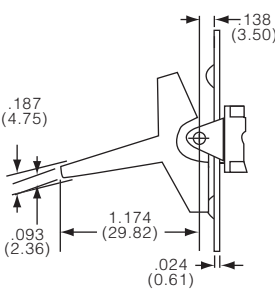
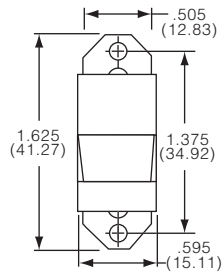
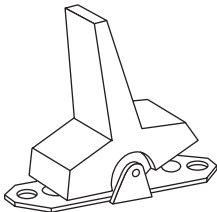

Gemini A Series Rocker/Paddle (Continued)

J60 paddle, snap-in

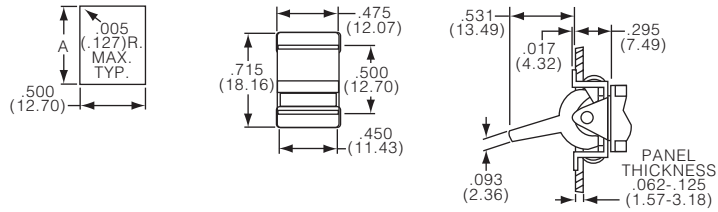

J61 paddle, snap-in w/beveled frame



J62 paddle, ssnap-in, w/beveled frame and LED

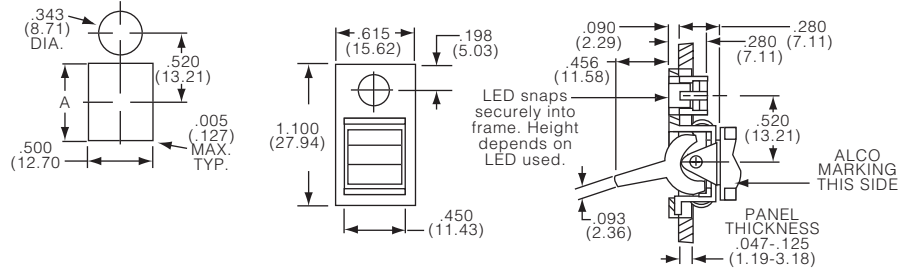
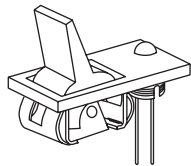

Rocker & Paddle Switches

Terminals



A right angle, rocker



A101J1AQ0

Single pole

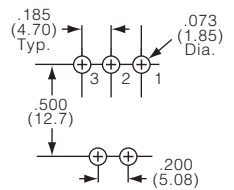
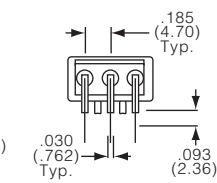
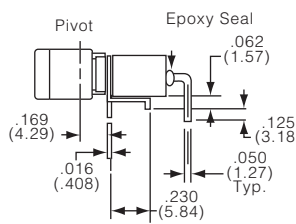
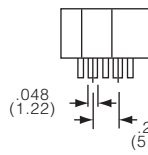

Terminal numbers viewed from top of P.C board



A201J1AQ0

Double pole

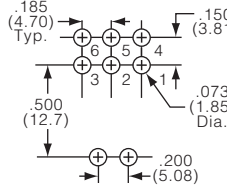
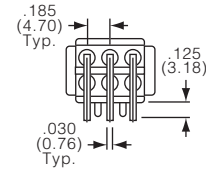
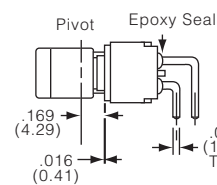
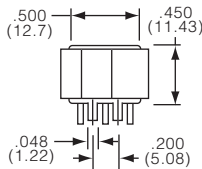

Gemini A Series Rocker/Paddle (Continued)

AV2 vertical, right angle, rocker

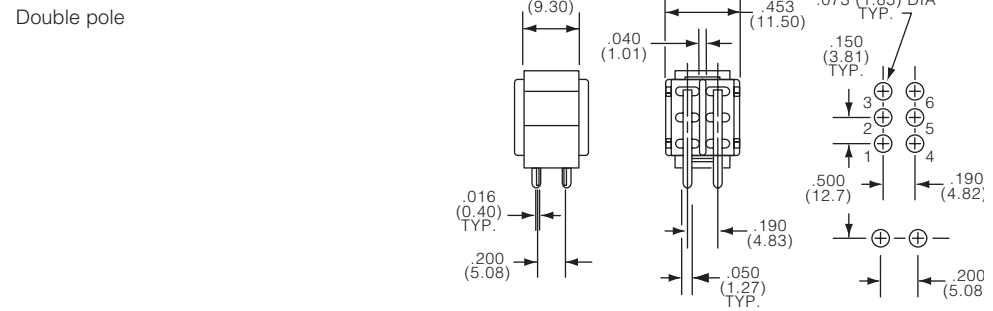
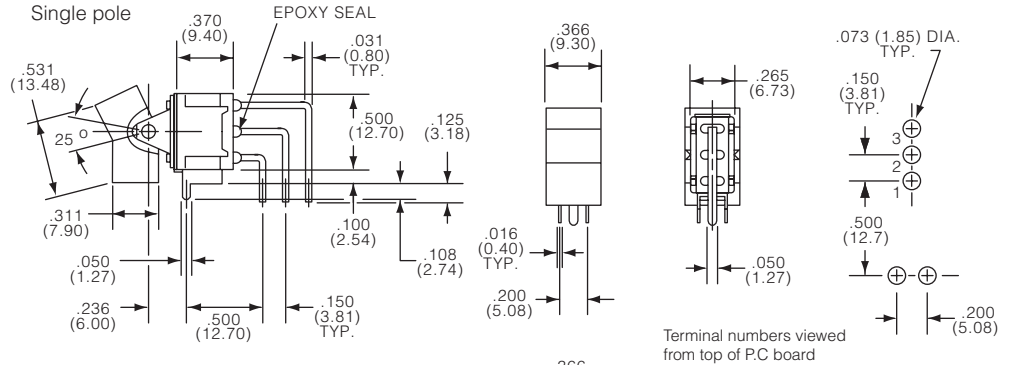

C printed circuit board, rocker

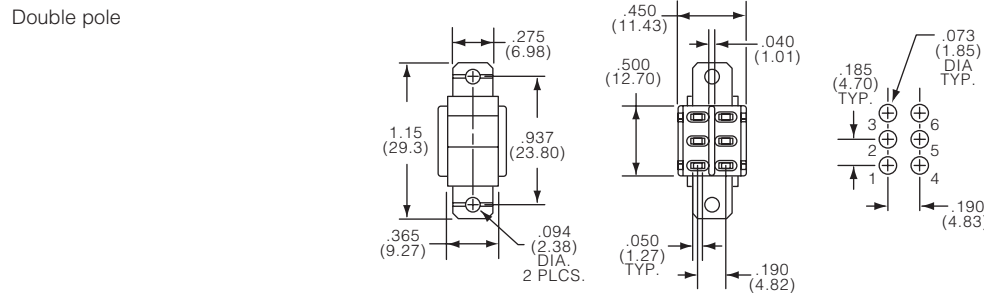
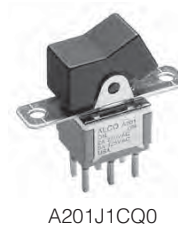
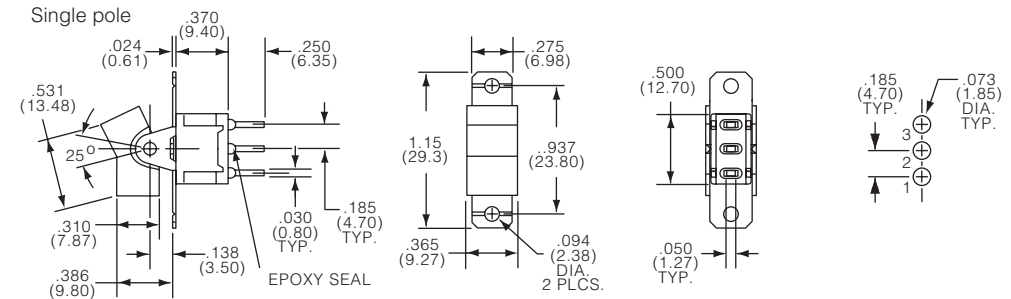
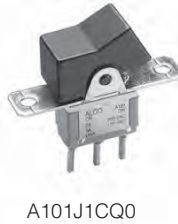

Rocker & Paddle Switches

Gemini A Series Rocker/Paddle (Continued)

V3 vertical with support bracket, rocker

Single pole

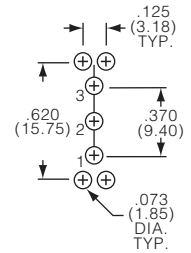
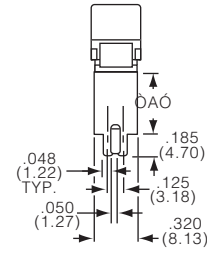

Double pole

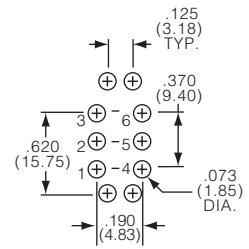
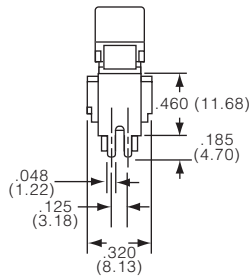

Z wire lug, rocker



A101J1ZQ0

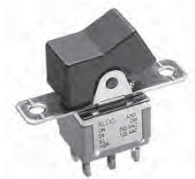
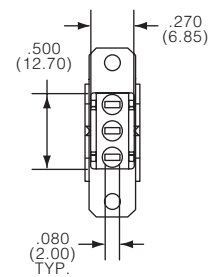
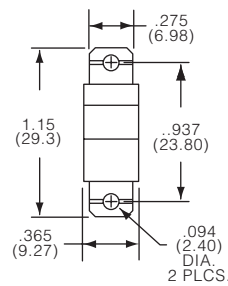
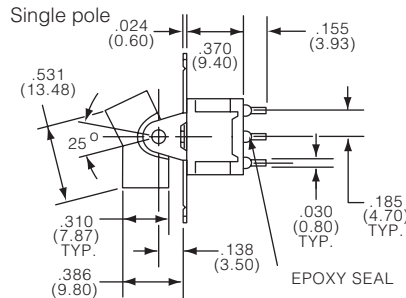

A201J1ZQ0

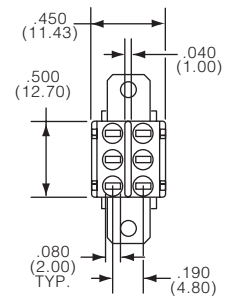
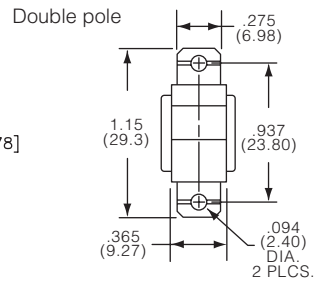
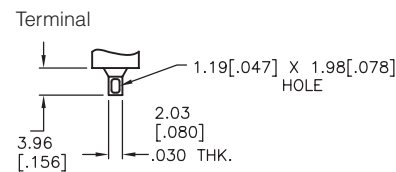

Gemini A Series Rocker/Paddle (Continued)

Z3 quick connect, rocker

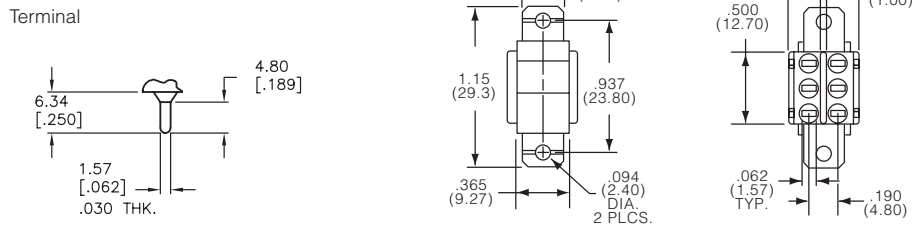

A right angle, paddle

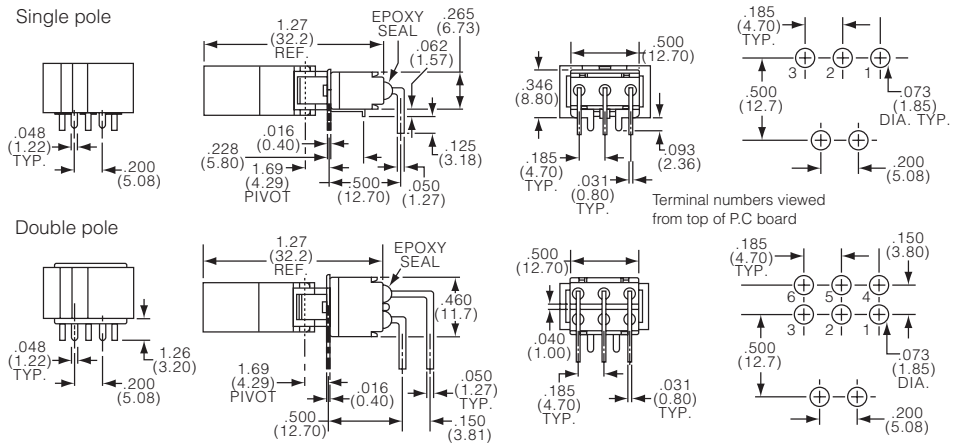

AV2 vertical, right angle, paddle

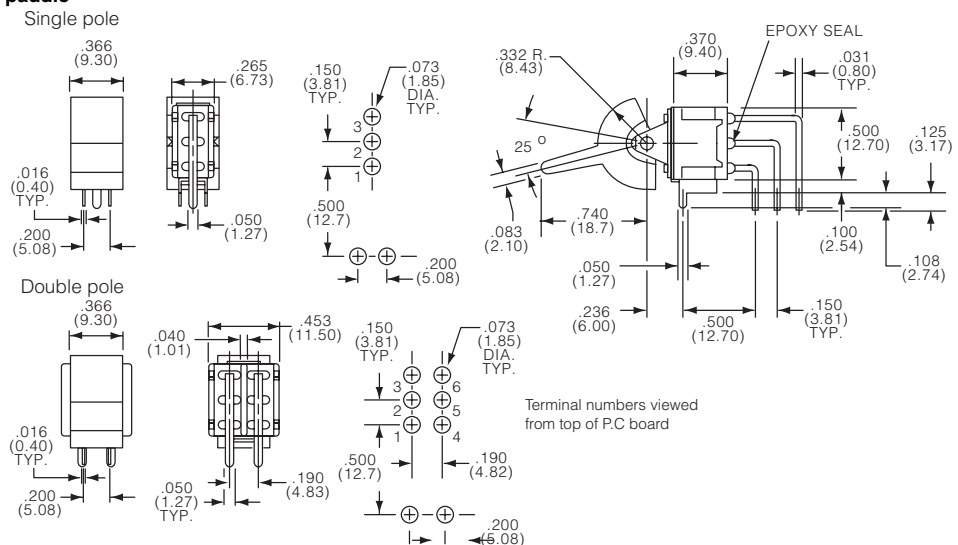

Rocker & Paddle Switches

Gemini A Series Rocker/Paddle (Continued)

C printed circuit board, paddle



A105J2CQ0

Single pole

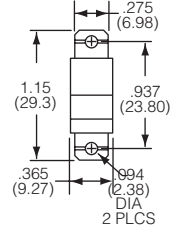

A205J2CQ0

Double pole



Z wire lug, paddle



A101J2ZQ0



A201J2ZQ0

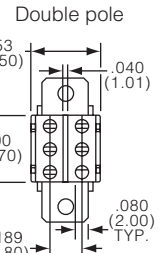
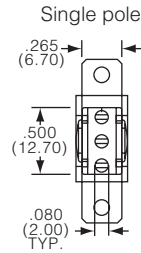
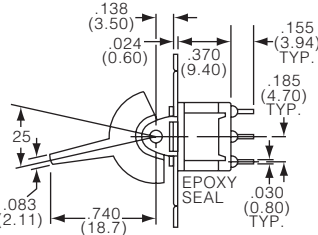
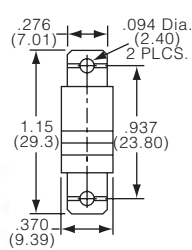

Gemini A Series Rocker/Paddle (Continued)

Product key	Poles	Function	Actuator	Terminals	Contacts	Act. color	Fr. color	Material	Part Number
A101J1AB004	single pole	On-On	small	right angle	gold	black	n/a	RoHS	1571986-7
A101J1AQ004					silver			compliant	1571986-8
A101J1AQ204						red			1571986-9
A101J1AV2B004				vertical R/A	gold	black			1-1571986-0
A101J1AV2Q004					silver				1-1571986-1
A101J1CG004				P.C.	Au on Ag				1-1571986-2
A101J1CQ004					silver				1-1571986-3
A101J1V3B004				br. .620(15.75)	gold				1-1571986-4
A101J1V3Q004					silver				1-1571986-5
A101J1ZB004				wire lug	gold				1-1571986-6
A101J1ZQ004					silver				1-1571986-7
A101J2AV2Q004				vertical R/A					1-1571986-8
A101J2ZB904				wire lug	gold	white			1-1571986-9
A101J2ZQ004					silver	black			2-1571986-0
A101J3V3Q204			large	br. .620(15.75)		red			2-1571986-1
A101J3ZQ004				wire lug		black			2-1571986-2
A101J4ZQ004									2-1571986-3
A101J4ZQ804						gray			2-1571986-4
A101J50AV2Q004			snap-in	vertical R/A		black			2-1571986-5
A101J50V3Q004				br. .620(15.75)					2-1571986-6
A101J50V3Q204						red			2-1571986-7
A101J50ZQ004				wire lug		black			2-1571986-8
A101J51CB0004			snap-in, frame	P.C.	gold		black		2-1571986-9
A101J51Z3G0004				quick c.	Au on Ag				3-1571986-0
A101J51Z3Q0004					silver				3-1571986-1
A101J51ZB0004				wire lug	gold				3-1571986-3
A101J51ZQ0004					silver				3-1571986-4
A101J51ZQ2004						red			3-1571986-5
A101J61ZQ0004						black			3-1571986-6
A103J1AV2B004		On-Off-On	small	vertical R/A	gold		n/a		3-1571986-8
A103J1AV2Q004					silver				3-1571986-9
A103J1V3Q004				br. .620(15.75)					4-1571986-0
A103J1ZQ004				wire lug					4-1571986-1
A103J2CB004				P.C.	gold				4-1571986-2
A103J2ZQ004				wire lug	silver				4-1571986-3
A103J3ZQ004			large						4-1571986-4
A103J51ZQ0004			snap-in, frame				black		4-1571986-5
A103J61ZQ0004									4-1571986-6
A105J1AQ004		(On)-Off-(On)	small	right angle			n/a		4-1571986-9
A105J1AV2Q004				vertical R/A					5-1571986-0
A105J1CQ004				P.C.					5-1571986-1
A105J1V3B004				br. .620(15.75)	gold				5-1571986-2
A105J1ZQ004				wire lug	silver				5-1571986-3
A105J2AQ004				right angle					5-1571986-4
A105J2AV2Q004				vertical R/A					5-1571986-5
A105J2ZQ004				wire lug					5-1571986-6
A105J3CQ004			large	P.C.					5-1571986-7
A105J3CQ2004						red	black		5-1571986-8
A105J3ZQ004				wire lug		black	n/a		5-1571986-9
A105J4ZQ004									6-1571986-0
A105J51ZQ0004			snap-in, frame				black		6-1571986-1
A105J52ZQ2004			snap-in, f., LED			red			6-1571986-2
A105J61ZG0004			snap-in, frame		Au on Ag	black			6-1571986-3
A105J61ZQ0004					silver				6-1571986-4
A107J51ZQ0004		On-Off-(On)							6-1571986-5
A107J61ZQ0004									6-1571986-6
A108J1V3Q004		On-(On)	small	br. .620(15.75)			n/a		6-1571986-7
A108J1ZQ004				wire lug					6-1571986-8
A108J51ZQ0004			snap-in, frame				black		6-1571986-9
A108J61ZQ0004									7-1571986-0

Gemini A Series Rocker/Paddle (Continued)

Product key	Poles	Function	Actuator	Terminals	Contacts	Act. color	Fr. color	Material	Part Number
A201J1AQ004	double pole	On-On	small	right angle		black	n/a	RoHS compliant	1571987-2
A201J1AQ204						red			1571987-3
A201J1AV2Q004				vertical R/A		black			1571987-4
A201J1CQ004				P.C.					1571987-5
A201J1V3Q004				br. .620(15.75)					1571987-6
A201J1ZQ004				wire lug					1571987-7
A201J2CQ004				P.C.					1571987-8
A201J2ZQ004				wire lug					1571987-9
A201J3ZB004			large		gold				1-1571987-0
A201J3ZQ004						silver			
A201J50AV2Q004			snap-in	vertical R/A					1-1571987-2
A201J50AV2Q804							gray		
A201J50ZQ004				wire lug		black			1-1571987-4
A201J51ZQ0004			snap-in, frame				black		1-1571987-5
A201J51ZQ9904							white	white	
A201J61Z3Q0004				quick c.		black	black		1-1571987-8
A201J61ZQ0004				wire lug					1-1571987-9
A203J1AQ004		On-Off-On	small	right angle			n/a		2-1571987-0
A203J1AV2Q004					vertical R/A				
A203J1CQ204				P.C.		red			2-1571987-2
A203J1ZQ004				wire lug		black			2-1571987-4
A203J51ZQ0004			snap-in, frame				black		2-1571987-6
A203J61ZQ0004									
A205J1AV2Q004		(On)-Off-(On)	small	vertical R/A			n/a		2-1571987-9
A205J1ZQ004					wire lug				
A205J2CQ004				P.C.					3-1571987-1
A205J2ZQ004				wire lug					3-1571987-2
A205J51ZQ0004			snap-in, frame				black		3-1571987-3
A205J61ZQ0004									
A207J1ZQ004		On-Off-(On)	small				n/a		3-1571987-5
A207J3ZQ004					large				
A207J51ZQ0004			snap-in, frame				black		3-1571987-7
A207J61ZQ0004									
A208J1V3Q004		On-(On)	small	br. .620(15.75)			n/a		4-1571987-0
A208J51ZQ0004					snap-in, frame	wire lug			black
A208J61ZQ0004									4-1571987-2
A211J51ZQ0004		On-On-On							4-1571987-3
A213J61ZQ0004		On-On-(On)							4-1571987-4

Rocker & Paddle Switches

Gemini AE Series Rocker/Paddle

Features

- Multiple actuator colors available
- G and Q contacts UL® recognition
- Sealed to IP67 select series



Typical performance characteristics

Contact configuration SPST, DPST
 Contact timing break-before-make
 Contact rating max. B contacts: 0.4 VA @ 20 V max. AC or DC
 G contacts: 0.4 VA @ 20 V max. AC or DC or
 5 A @ 120 VAC or 28 VDC (resistive) or
 2 A @ 250 VAC (resistive)
 Q contacts: 5 A @ 120 VAC or 28 VDC (resistive) or
 2 A @ 250 VAC (resistive)
 Electrical life. 6,000 cycles at rated load
 Mechanical life. 40,000 cycles
 Contact resistance. max. 10 mOhms initial @ 2-4 VDC, 100 mA
 Insulation resistance min. 1,000 MOhms
 Dielectric strength. 1,000 Vrms at sea level
 Standards and specs. UL® recognition on G & Q contacts

Environmental specification

Operating temperature -30°C to 85°C
 Storage temperature -40°C to 85°C
 Solder heat resistance wave solder capable to 265°C

Material specifications

Contacts & terminals. B contacts: copper alloy w/ gold over nickel
 G contacts: copper alloy w/ silver
 Q contacts: copper alloy w/ gold over silver
 Actuator phenolic
 Case. nylon red, UL94 V-0
 Support bracket brass/ tin plated
 Seal. epoxy UL94 V-1
 O ring. pvc, black
 Spring music wire
 Mounting bracket & rocker cap. nylon UL94 V-1
 Retainer stainless steel
 RoHS Directive 2002/95/EC compliant

Product key		Typical product key							
		AE	1	01	J1	A	Q	0	04
Type	Rocker/Paddle Switch								
Number of poles	1 single pole	2 double pole							
Function	01 On-On	07 On-Off-(On)							
	05 (On)-Off-(On)	08 On-(On)							
Actuator	Rocker		Paddle						
	J1 standard	J2 standard							
	J50 small	J60 small							
Terminals	A right angle		W wire wrap .736 (18.7)						
	AV2 vertical R/A		W4 wire wrap 1.062 (27.00)						
	C P.C.		Z wire lug						
	V3, V4 vertical with support bracket		Z3 quick connect						
Contacts	B gold		G gold over silver		Q silver				
Actuator color	0 black (std.)		2 red						
Material	04 RoHS compliant								

Gemini AE Series Rocker/Paddle (Continued)

Function



Codes 01, 05, 07 and 08

Code	Positions			
01	2 positions	On	None	On
08	2 positions	On	None	(On)
	Term. conn.	1 - 2	---	2 - 3
05	3 positions	(On)	Off	(On)
07	3 positions	On	Off	(On)
	Terminals connected	1 - 2 4 - 5	---	2 - 3 5 - 6

Off mechanical position, no electrical connection
 (On) momentary mechanical position and electrical connection
 None no mechanical position

Actuator



J1, J50 rockers standard and small rocker

J1 standard rocker



mounting provided with C or Z terminal types

J50 small rocker

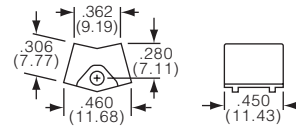

mounting provided with C or Z terminal types

J2, J60 paddles standard and small paddle

J2 standard paddle

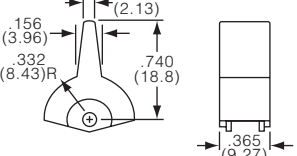
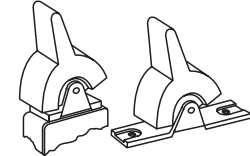

mounting provided with C or Z terminal types

J60 small paddle

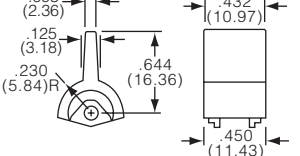
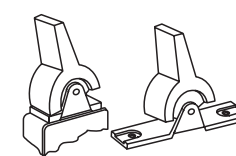

mounting provided with C or Z terminal types

Terminals



A right angle

Single pole

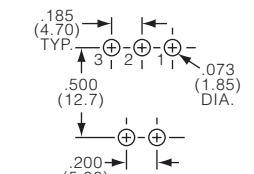
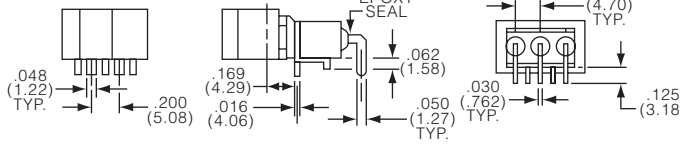

Double pole

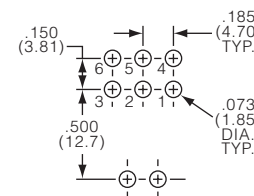
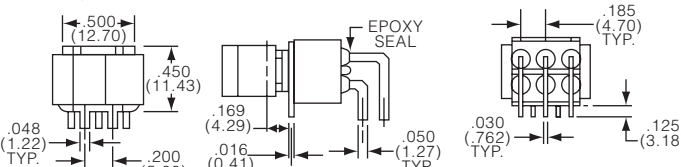

Gemini AE Series Rocker/Paddle (Continued)

AV2 vertical right angle

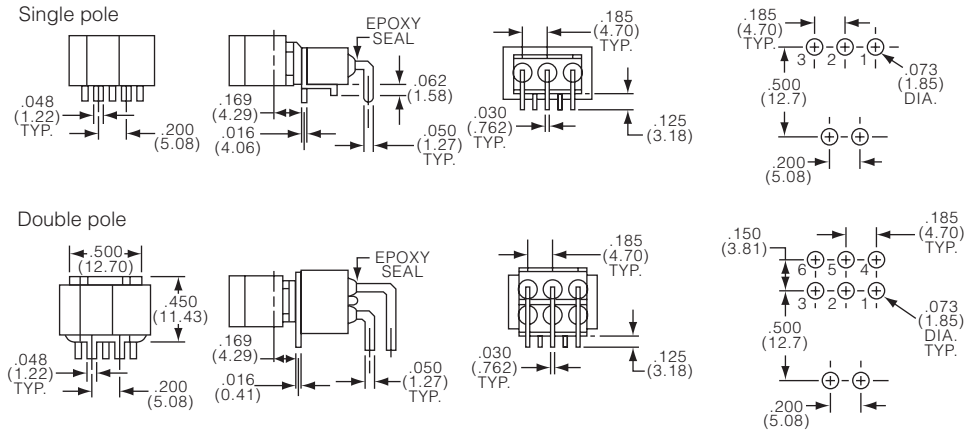

V3, V4 vertical with support bracket

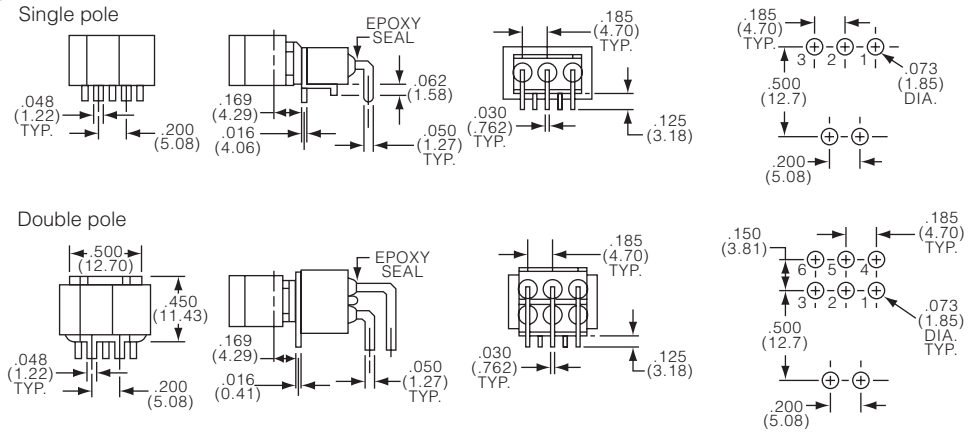

Codes C, W, W4, Z and Z3 rpc board, wire wrap, solder lug and quick connect

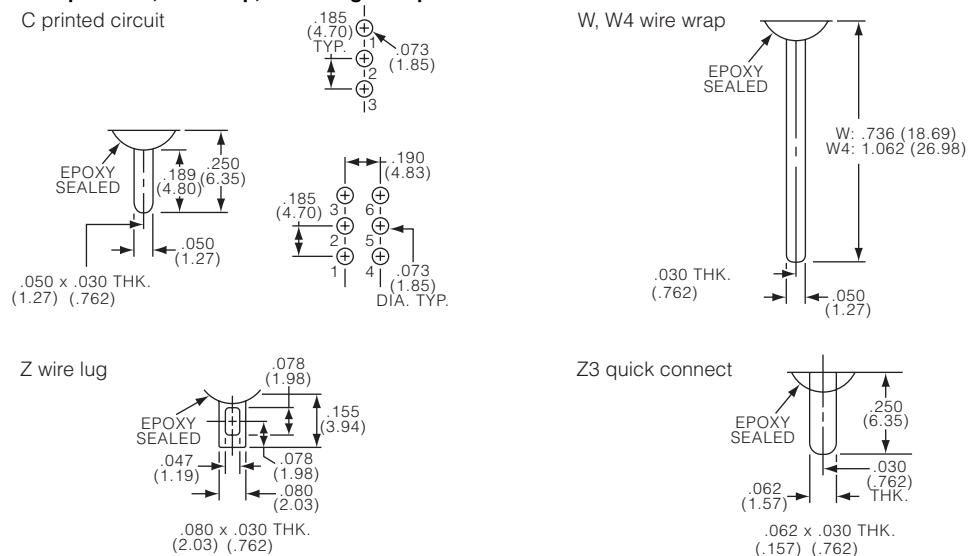

Rocker & Paddle Switches

Gemini AE Series Rocker/Paddle (Continued)

Product key	Poles	Function	Actuator	Terminals	Contacts	Act. color	Material	Part Number
AE101J1AB004	single pole	On-On	standard	right angle	gold	black	RoHS compliant	1571988-1
AE101J1AQ004					silver			1571988-2
AE101J1A404						yellow		1571988-3
AE101J1AV2Q004				vertical R/A		black		1571988-4
AE101J1V3B004				br. .620(15.75)	gold			1571988-5
AE101J1V3Q004					silver			1571988-6
AE103J50V3B004		On-Off-On	small		gold			1571988-7
AE103J60V3Q204					silver	red		1571988-8
AE105J1AQ004		(On)-Off-(On)	standard	right angle		black		1571988-9
AE105J1V3B004				br. .620(15.75)	gold			1-1571988-0
AE105J1ZB004				wire lug				1-1571988-1
AE105J60V3B004			small	br. .620(15.75)				1-1571988-2
AE107J1AQ004		On-Off-(On)	standard	right angle	silver			1-1571988-3
AE107J1ZQ004				wire lug				1-1571988-4
AE108J1ZQ004		On-(On)						1-1571988-5
AE108J60V3B004			small	br. .620(15.75)	gold			1-1571988-6
AE201J1AQ004	double pole	On-On	standard	right angle	silver			1571989-1
AE201J1AV2Q004				vertical R/A			1571989-2	
AE201J1V3B004				br. .620(15.75)	gold			1571989-3
AE201J2AQ204				right angle	silver	red		1571989-4
AE203J1AQ004		On-Off-On				black		1571989-5
AE205J50V3B004		(On)-Off-(On)	small	br. .620(15.75)	gold			1571989-6
AE205J60V3B004								1571989-7
AE208J50V3B004		On-(On)						1571989-8

Rocker & Paddle Switches